



Item # _____

Model EM-22 Meat Grinder



Meat Grinder Model EM-22



Model EM-22



Safety and Convenience Features

Berkel Model EM-22 meat grinder is a high performance, versatile machine. Its compact, stainless steel design with an increased output height allows for a wide range of receiving containers for finished product. The unit's grinding body is separated from the motor to help prevent heat transfer to the product. This feature, combined with a short feed screw, helps produce less heat, which increases the overall shelf life of ground products and improves the quality of grind without the loss of product color. The EM-22 has a dependable, oil-filled gearbox assembly with hardened gears to assure quiet operation and years of service under normal conditions. A non-removable, top cover and tray safety guard are standard. No-Volt release prevents activation of the grinder in the event of a power interruption, requiring the operator to restart the grinder. The output housing removes easily without tools to facilitate cleaning.

Standard Features

- ▶ Compact stainless steel design with an increased output height that allows for a wide range of receiving containers
- ▶ Short feed screw helps to produce less heat, which increases the overall shelf life of ground products; quality of grind is improved without the loss of product color
- ▶ Large stainless steel tray holds more product increasing productivity
- ▶ 1-speed, 1.25 HP, totally enclosed and permanently lubricated motor, thermally protected
- ▶ Furnished in 115/60/1, 8.0 amp, AC, ETL listed
- ▶ Dependable, oil-filled gearbox assembly with hardened gears assures quiet operation
- ▶ Grinding body is separated from the motor to prevent heat transfer to the product and removes and disassembles easily without tools to facilitate cleaning
- ▶ 3/16" (5 mm) and 5/16" (8 mm) alloy steel plates are standard; optional 1/8" (3 mm), 1/4" (6 mm) and 3/8" (10 mm) plates are also available
- ▶ Capacity of up to 660 lbs. (300 kg.) per hour
- ▶ Highly reliable, moisture resistant, push button, on/off switch; No-Volt release prevents activation of the grinder in the event of a power interruption; operator must restart the grinder
- ▶ Housing, product tray, rammer, head and feed screw are stainless steel; unit disassembles quickly without tools for easy cleaning
- ▶ Attached 6-foot, flexible, 3-wire cord and plug for grounded receptacle

Accessories

- 1/8" (3 mm) alloy steel plate
- 3/16" (5 mm) alloy steel plate
- 1/4" (6 mm) alloy steel plate
- 5/16" (8 mm) alloy steel plate
- 3/8" (9.5 mm) alloy steel plate

Approved By: _____ Date _____

Berkel Company • 4406 Technology Drive • South Bend, IN 46628-9700
574-232-8222 • 800-348-0251 • FAX 888-888-2838 • www.berkel.com

Berkel

Model EM-22

Meat Grinder

Model No.	Output Capacity	Product Dimensions		
		Width A	Depth B	Height C
EM-22	660 lbs. (300 kg.)	13-3/4" (349 mm)	22" (559 mm)	17" (432 mm)

Motor	Electrical	Knife RPM	Weight Net	Ship	Box Dimensions		
					Width	Depth	Height
1-speed 1.25 HP	115/60/1	235	80 lbs. (36 kg)	91 lbs. (41 kg)	17-3/4" (451 mm)	25-1/4" (641 mm)	19-1/2" (495 mm)

Specifications

Design: Compact, stainless steel design with an increased output height allows for a wide range of receiving containers. The large stainless steel tray 13-3/4" (349 mm) width x 3" (76 mm) depth x 19-1/2" (495 mm) length, holds more product increasing productivity.

Standard Features: Stainless steel product tray and rammer, alloy steel plates with 3/16" (5 mm) and 5/16" (8 mm) holes, hardened steel cutting knife, knife puller and protective guard to keep hands from feed screw are standard.

Grinding Housing: Grinding body is separated from the motor to help prevent heat transfer to the product and removes and disassembles easily without tools to facilitate cleaning. The short feed screw helps to produce less heat, which increases the overall shelf life of ground products; quality of grind is improved without the loss of product color. Includes #22 size 3-1/4" (82 mm) diameter head; 3/16" (5 mm) and 5/16" (8 mm) alloy steel plates are standard; optional 1/8" (3 mm), 1/4" (6 mm) and 3/8" (10 mm) plates are also available.

Motor: 1-speed, 1.25 HP, totally enclosed, permanently lubricated ball bearings, thermally protected.

Electrical: Furnished in 115/60/1, 8.0 amp, AC, ETL listed.

Finish/Construction: Housing, product tray, head, rammer and feed screw are stainless steel. The unit disassembles quickly without tools for easy cleaning.

Transmission: Dependable, oil-filled gearbox assembly with hardened gears assures quiet operation.

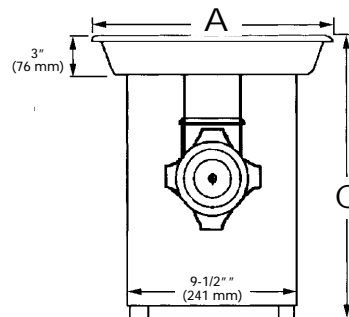
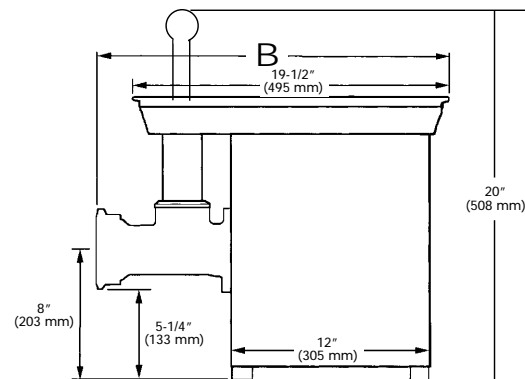

Switch: Highly reliable, moisture resistant, push button, on/off switch. Includes No-Volt release, which prevents activation of the grinder in the event of a power interruption, requiring the operator to restart the grinder.

Cord and Plug: Attached 6-foot, flexible, 3-wire cord and plug for grounded receptacle.

Warranty: All parts, service and travel coverage for one year, excluding wear items.

As we continually strive to improve our products, specifications are necessarily subject to change without notice.

Berkel Company • 4406 Technology Drive • South Bend, IN 46628-9700
574-232-8222 • 800-348-0251 • FAX 888-888-2838 • www.berkel.com