



Item # _____

Model 839A Automatic Gravity Feed Slicer



Automatic Gravity Feed Slicer Model 839A



Model 839A



Safety and Convenience Features

Berkel Model 839A automatic gravity feed slicer features Berkel's hollow ground chromium-plated, carbon steel knife and built-in, single lever, dual-action sharpener with convenient handle located on the sharpener cover. The permanent, tapered guard covers the non-slicing portion of the knife even when the center plate is removed. The 45° table with front-mounted, articulating pusher and fence make product feed easier, creating more consistent and uniform slices with less waste. The single-speed carriage operates at 52 slices per minute. The 1/2 HP motor, 14" knife and large product table are ideal for handling oversize meats, cheeses and a variety of other products. The 839A slicer is easy to clean and disassembles quickly without tools.

Standard Features

- ▶ Separate 1-speed, 1/2 HP, totally enclosed and permanently lubricated motors for the knife and carriage
- ▶ Furnished in 115/60/1, 5.8 amp, AC, ETL listed
- ▶ Carriage speed is 52 slices per minute
- ▶ Finish is stainless steel and sanitary anodized aluminum; unit disassembles quickly without tools for easy cleaning
- ▶ 45° Product table with front-mounted, articulating pusher and fence
- ▶ Nominal 14" (350 mm) diameter; hollow ground, hardened and polished forged chromium-plated carbon steel knife
- ▶ Carriage handles food up to 11" (280 mm) wide, by 8-1/2" (216 mm) high or 8-1/2" (216 mm) diameter
- ▶ Precise slice adjustment to a thickness of 3/4" (19 mm)
- ▶ Built-in, non-removable, top-mounted, two stone knife sharpener with single lever, dual-action system
- ▶ Permanent, tapered knife ring guard covers non-slicing portion of knife even when the center plate is removed; ring guard design provides more room behind the knife for easy cleaning
- ▶ No-Volt release prevents activation of the slicer in the event of a power interruption; operator must restart the slicer
- ▶ Positive, moisture protected, on/off switches and power indicator light
- ▶ Attached 6-foot, flexible, 3-wire cord and plug for grounded receptacle

| |
|----------------------------------|
| Approved By: _____ Date _____ |
|----------------------------------|

Berkel Company • 4406 Technology Drive • South Bend, IN 46628-9700
574-232-8222 • 800-348-0251 • FAX 888-888-2838 • www.berkel.com

Berkel

Model 839A

Automatic Gravity Feed Slicer

| Model No. | Cutting Capacity | Carriage Speed | Slice Thickness | Knife Diameter | Product Dimensions | | |
|-----------|---|----------------|--------------------|----------------|--------------------|-----------------|-----------------|
| | | | | | Width A | Depth B | Height C |
| 839A | 11" (280mm) wide 8-1/2" (216 mm) high 8-1/2" (216 mm) dia | 52 SPM | to 3/4" (19 mm) | 14" (350mm) | 25" (635 mm) | 29" (737 mm) | 29" (737 mm) |

| | Motor | Electrical | Weight | Box Dimensions | | |
|--|-------------------|------------|--|-----------------|-----------------|-----------------|
| | | | | Width | Depth | Height |
| | 1-speed 1/2 HP | 115/60/1 | Net 138 lbs. (63 kg.) Ship 170 lbs. (77 kg) | 34" (864 mm) | 30" (762 mm) | 37" (940 mm) |

Specifications

Motors: Separate 1-speed, 1/2 HP, totally enclosed motors for the knife and carriage, permanently lubricated ball bearings, thermally protected.

Electrical: Furnished in 115/60/1, 5.8 amp, AC, ETL listed.

Carriage Speed: 52 slices per minute.

Finish/construction: All food contact areas are stainless steel or anodized aluminum including the pusher, gauge plate, product table, center plate, knife ring guard and one-piece base. Slicer disassembles quickly without tools for easy cleaning.

Knife: Nominal 14" (350 mm) diameter, hollow ground, hardened and polished forged chromium-plated carbon steel.

Cutting Capacity: Carriage handles food up to 11" (280 mm) wide by 8-1/2" (216 mm) high or 8-1/2" (216 mm) diameter

Slice Thickness: Precision system provides infinite slice adjustment and consistent cuts of hard or soft foods from tissue thin to 3/4" (19 mm).

Full Gravity Feed: Full 45° angle feed requires less mechanical pressure. Equipped with a front-mounted, articulating, anodized aluminum pusher and fence to hold product and minimize waste.

Knife Sharpener: Built-in, top-mounted, two stone, single lever, dual-action system for a lasting, razor-sharp edge.

Knife Ring Guard: Permanent, tapered guard covers non-slicing portion of knife edge even when the center plate is removed. The ring guard is designed to provide added room behind the knife for easy cleaning.

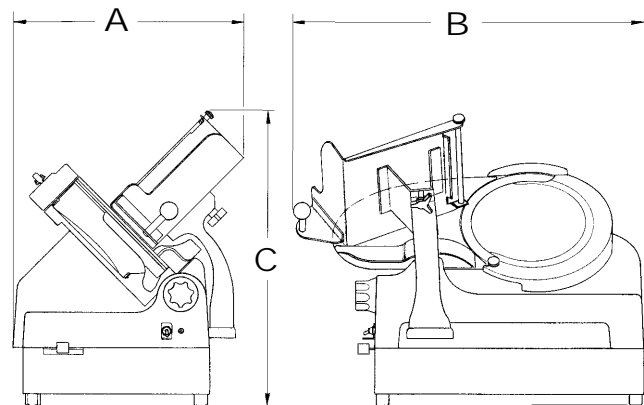

No-Volt Release: Prevents activation of the slicer in the event of a power interruption. Operator must restart the slicer.

On/Off Switch: Highly reliable, moisture resistant, on/off switches and power indicator light.

Cord and Plug: Attached 6-foot, flexible, 3-wire cord and plug for grounded receptacle.

Warranty: All parts, service and travel coverage for one year, excluding wear items.

As we continually strive to improve our products, specifications are necessarily subject to change without notice.

Automatic Gravity Feed Slicer Model 839A

Berkel

Berkel Company • 4406 Technology Drive • South Bend, IN 46628-9700
574-232-8222 • 800-348-0251 • FAX 888-888-2838 • www.berkel.com